

DRAWING IS PRODUCED USING THE IRISH TRANSVERSE MERCATOR (ITM) GEOGRAPHIC COORDINATE SYSTEM

A1

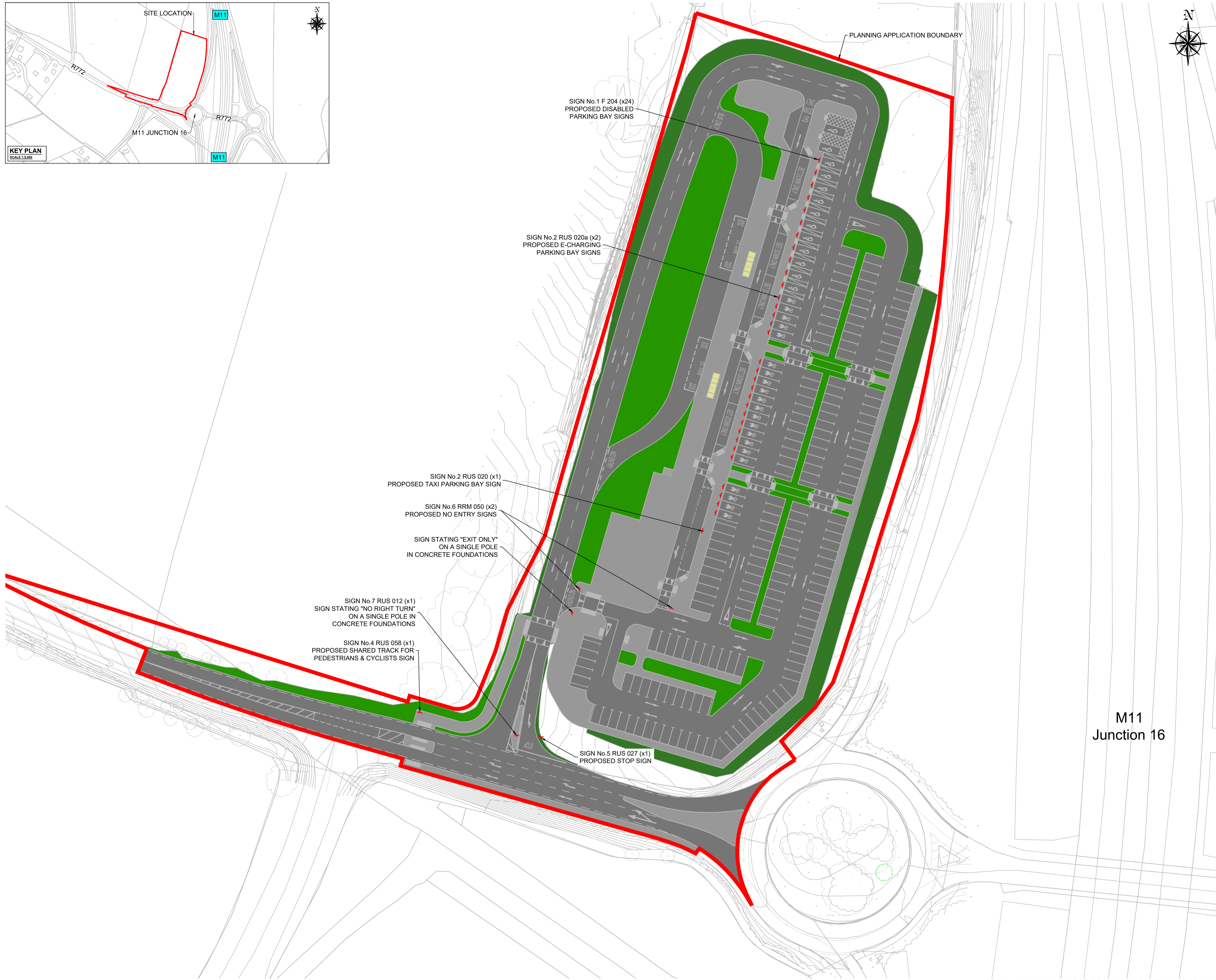

**Tionscadal Éireann
Project Ireland
2040**



M11
Junction 16

LEGEND:

- 1 F 204 PROPOSED DISABLED PARKING BAY SIGN
- 2 RUS 020a PROPOSED E-CHARGING PARKING BAY SIGN
- 3 RUS 020 PROPOSED TAXI PARKING BAY SIGN
- 4 RUS 058 PROPOSED SHARED TRACK FOR PEDESTRIANS & CYCLISTS SIGN
- 5 RUS 027 PROPOSED STOP SIGN
- 6 RRM 050 PROPOSED NO ENTRY SIGN
- 7 RUS 012 PROPOSED NO RIGHT TURN

NOTE

ALL SIGNS TO BE ERECTED SIGN ON A SINGLE POLE IN CONCRETE FOUNDATIONS

P01	ISSUED FOR PLANNING	SM	IR	25/10/24
Rev	Description	Drawn	Checked	Date

Clifton Scannell Emerson Associates

Clifton Scannell Emerson Associates Limited
Consulting Engineers,
3rd Floor The Highline,
Bakers Point, Pottery Road,
Dun Laoghaire, Co. Dublin,
Ireland, A96 KW29

T. +353 1 288 5006
F. +353 1 283 3406
E. info@csea.ie
W. www.csea.ie

Client: **WICKLOW COUNTY COUNCIL**
Project: **ASHFORD PARK AND RIDE FACILITY**
Dwg. Title: **PROPOSED ROAD SIGNAGE LAYOUT**

Drawn By: **SM** Date: **OCT 2024**
Checked By: **IR** Scale: **1:500 @ A1** CSEA Job No. **20_008L**

Project Code	Originator	Zone/Phase	Level	Type	Role	Dwg. No.
20_008L	CSE	GEN	XX	DR	C	3201

Status Code: **S02** Suitability Description: **PART VIII APPROVAL**

Revision: **P01** Project Status: **FOR PLANNING**